

REV.	DESCRIPTION	ECN	DATE
D	CHANGE PER ECN	1120_10089	9-16-24

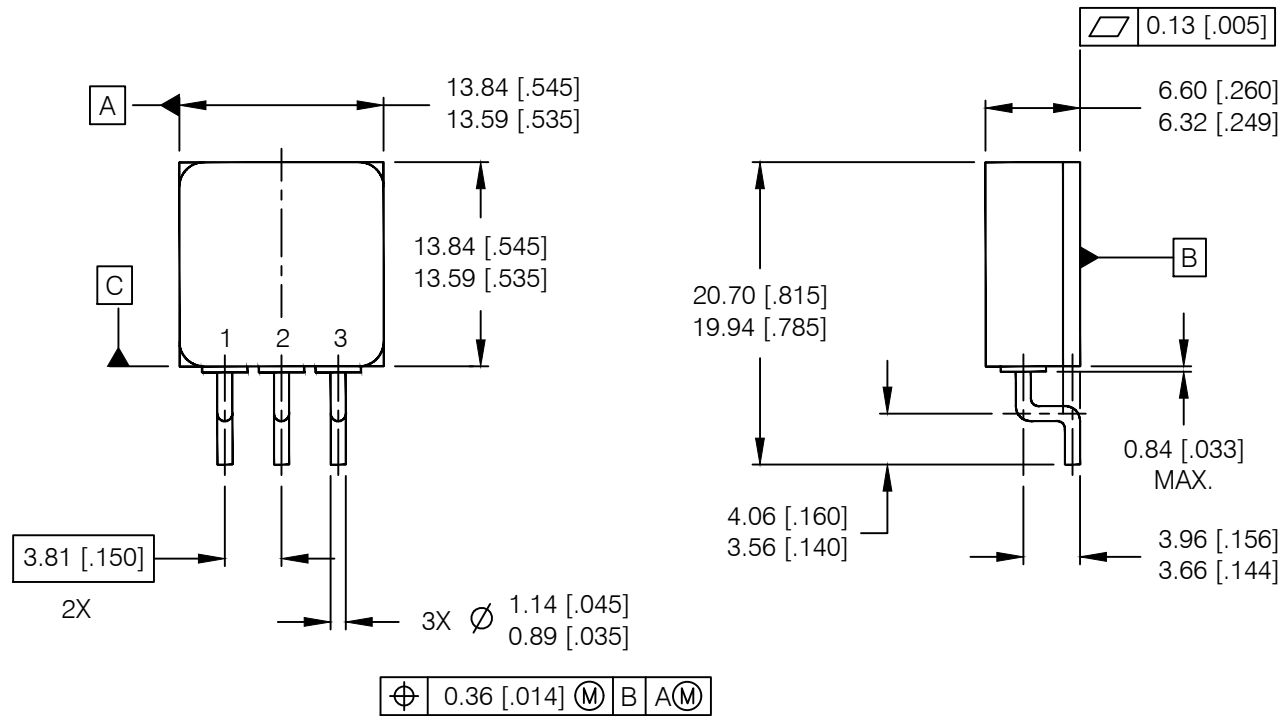

NOTES:

1. ALL DIMENSIONS ARE SHOWN IN MILLIMETERS [INCHES].
2. THIS OUTLINE IS A MODIFIED TO-254AA JEDEC OUTLINE.
3. STANDARD FINAL FINISH ON ALL TERMINALS IS SOLDER ALLOY 63%Sn 37%Pb.

SURFACE MOUNT DEVICE:
LEADS SHALL BE MAINTAINED
FOR COPLANARITY.

IOR HiRel
An Infineon Technologies Company

TITLE: TO-254AA TABLESS,
STD & LOW OHMIC, SURFACE MOUNT
LEADFORM, PACKAGE OUTLINE

DRAWING NO.
D100746G-WEB

REV D